

Personal Audio System

Operating Instructions



ZS-RS60BT

http://www.sony.net/



WARNING

To reduce the risk of fire or electric shock, do not expose this apparatus to rain or moisture.

To reduce the risk of fire, do not cover the ventilation opening of the appliance with newspapers, tablecloths, curtains, etc. Do not expose the appliance to naked flame sources (for example, lighted candles).

To reduce the risk of fire or electric shock, do not expose this apparatus to dripping or splashing, and do not place objects filled with liquids, such as vases, on the apparatus.

As the main plug is used to disconnect the unit from the mains, connect the unit to an easily accessible AC outlet. Should you notice an abnormality in the unit, disconnect the main plug from the AC outlet immediately.

The unit is not disconnected from the AC power source (mains) as long as it is connected to the wall outlet, even if the unit itself has been turned off. Do not install the appliance in a confined space, such as a bookcase or built-in cabinet.

Excessive sound pressure from earphones and headphones can cause hearing loss.

Do not expose the batteries (battery pack or batteries installed) to excessive heat such as sunshine, fire or the like for a long time.

The nameplate is located on the bottom exterior.

For customers in Europe

Notice for customers: the following information is only applicable to equipment sold in countries applying EU directives This product has been manufactured by or on behalf of Sony Corporation, 1-7-1 Konan Minato-ku Tokyo, 108-0075 Japan. Inquiries related to product compliance based on European Union legislation shall be addressed to the authorized representative, Sony Deutschland GmbH, Hedelfinger Strasse 61, 70327 Stuttgart, Germany. For any service or guarantee matters, please refer to the addresses provided in the separate service or guarantee documents.

TRA REGISTERED No: ER36857/15 DEALER No: DA0096946/12

Personal Audio System is designed to be used for playing back music sources on CDs or USB devices, transferring music to USB devices, listening to radio stations, and listening to music on BLUETOOTH devices.

Power Sources

Connect the AC power cord **A**, or insert six R14 (size C) batteries (not supplied) into the battery compartment **B**.

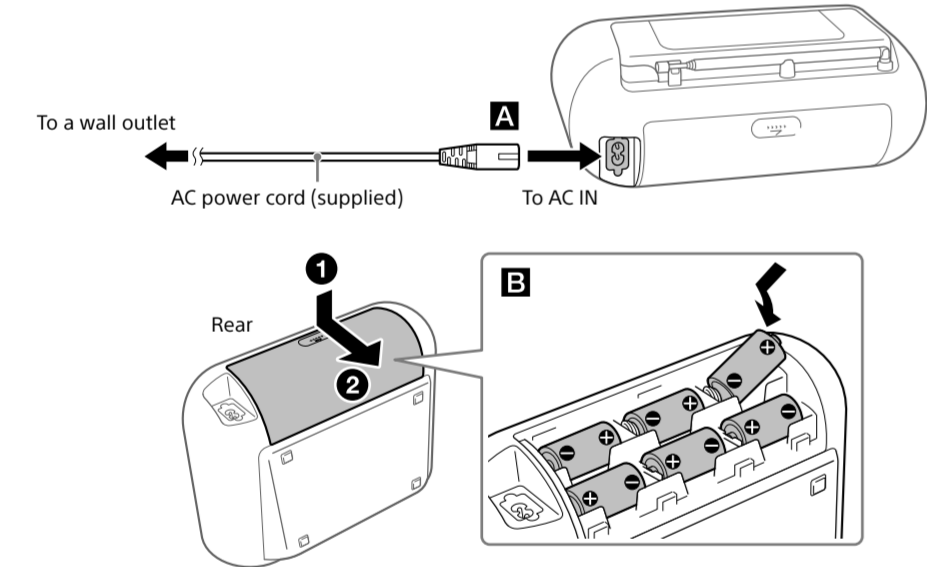

- When using the radio on batteries and the battery power drops to a certain level, the OPR/BATT indicator **18** dims or the power of the radio may go off during playback. If this happens, replace all the batteries with new ones. Even the OPR/BATT indicator **18** becomes dim, you can use the radio function for some time, although you cannot use the CD player. Before you replace the batteries, be sure to remove any CD and disconnect any USB devices or optional components from the unit.
- To use the unit on batteries, disconnect the AC power cord from the unit and the wall outlet.
- In standby mode with the AC power cord connected, "STANDBY" appears on the display.

To use the power-management function (European models only) This unit is equipped with an automatic standby function. With this function, the unit enters standby mode automatically after about 15 minutes if there is no operation or audio signal output. To turn standby mode on or off, press VOL - **4** while holding down **▲ 7**. Each time you press the buttons, "AUTO STANDBY ON" or "AUTO STANDBY OFF" appears on the display.

- The displayed content starts flashing on the display about 2 minutes before entering standby mode.
- The automatic standby function is not available with the FM/AM function.

Basic Operations

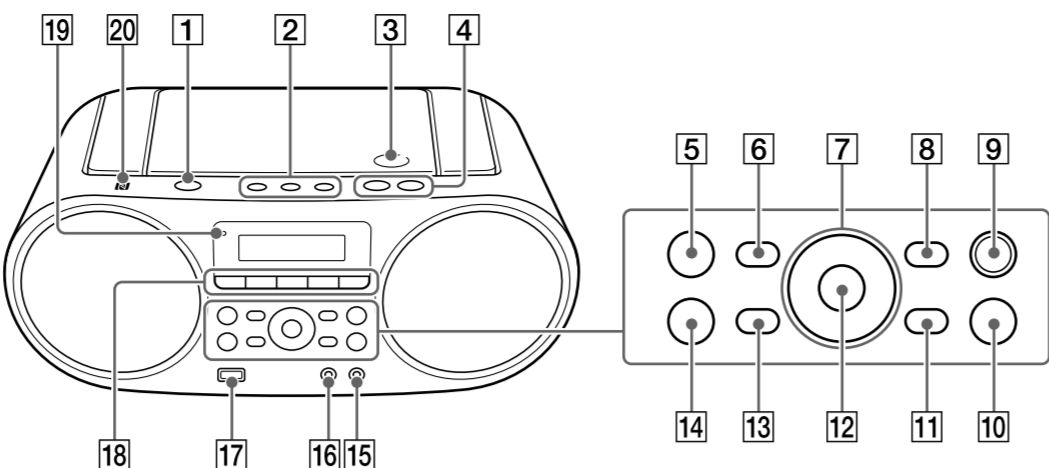

* **▶ 5** and VOL + **4** have a tactile dot.

Before using the unit

To turn the power on or off Press OPERATE **1**. You can also turn on the power of this unit using the direct power-on function (below). In this manual, operations are mainly explained using the direct power-on function.

To use the direct power-on function Press CD **18**, USB **18**, BLUETOOTH **18**, FM/AM **18**, AUDIO IN **18** or FAVORITE RADIO STATIONS (1-3) **2** while the unit is turned off. The power turns on with the relevant function selected.

To adjust the volume Press VOL + or - **4**.

To listen through headphones Connect headphones to the **1** (headphones) jack **16**.

To reinforce the bass Press MEGA BASS **18**. "MEGA BASS" lights up on the display. To return to normal sound, press the button again.

Playing a music disc

- Press CD **18** to turn on the CD function.
- Press PUSH OPEN/CLOSE **▲ 3**, place a disc in the CD compartment and then close the compartment cover.

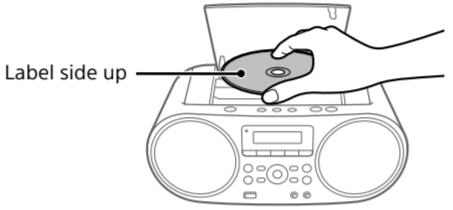

The disc is loaded and the disc information appears on the display.

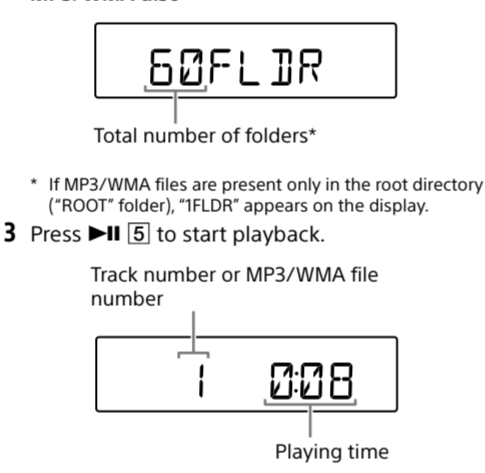

When you play an MP3/WMA disc, the folder name*1 and song title are displayed before the playing time*2 appears.

*1 If MP3/WMA files are present only in the root directory, "ROOT" appears on the display.
*2 If the playing time is longer than 100 minutes, "----" appears on the display.

Other operations	
To	Do this
Pause playback	Press ▶ 5 . To return to playback, press the button again.
Stop playback	Press ■ 14 . When you press ▶ 5 after playback is stopped, playback starts from the point where you stopped playback (Resume Play).
Select a folder on an MP3/WMA disc	Press ◀ 4 or ▶ 7 .
Select a track/file	Press ◀ 4 or ▶ 7 . You can skip tracks/files one by one.
Find a point in a track/file	Hold down ◀ 4 or ▶ 7 during playback, and release the button at the desired point. When locating a point while paused, press ▶ 5 to start playback after the desired point is found.

Tip To cancel the Resume Play, press **■ 14** while the CD is stopped.

Note Resume Play is cancelled in the following cases:
— When you open the CD compartment.
— When you turn off the power.

Example of folder structure and playing order The playing order of the folders and files is as follows. However, the playing order may differ from the original order on the USB device, depending on the recording method used.

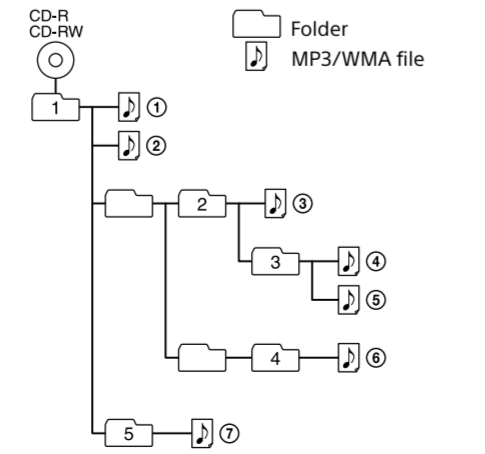

- Notes on MP3/WMA discs**
 - When a disc is loaded, the unit reads all the files on that disc. During this time, "READING" is flashing. If there are many folders or non-MP3/WMA files on the disc, it may take a long time for play to begin or for the next MP3/WMA file to start to play.
 - We recommend that non-MP3/WMA files or unnecessary folders are excluded when creating MP3/WMA discs.
 - During playback, audio files other than MP3 and WMA files are skipped even if those files are included in a folder.
 - The audio formats supported by this unit are as follows:
 - MP3: File extension ".mp3"
 - WMA: File extension ".wma"Note that even if the file name has the correct file extension but the actual file was created in a different audio format, this unit may produce noise or may malfunction.
 - MP3 PRO format is not supported.

- Folder names can be displayed with up to 32 characters, including quotation marks.
- File names can be displayed with up to 32 characters, including quotation marks and file extensions.
- Characters and symbols that cannot be displayed by the unit will appear as "...".
- This unit conforms to version 1.0, 1.1, 2.2, 2.3 and 2.4 of the ID3 tag format for MP3 files, the WMA tag format defined by the ASF specification (Advanced Systems Format) for WMA files, and the AAC tag format for AAC files. When a file has the ID3, WMA or AAC tag information, the song title, artist name, and album name will be displayed. If a file does not have the tag information, the unit displays as follows:
 - File name instead of the song title.
 - "NO ARTIST" message instead of the artist name.
 - "NO ALBUM" message instead of the album name.ID3, WMA and AAC tag information can be displayed up to 64 characters.

Transferring music from a disc to a USB device

You can transfer a whole disc (CD SYNC transfer) or the selected playing track or file (REC1 transfer) to a USB device (digital music player or USB storage media, etc.). When transferring from a CD, the tracks are transferred as MP3 files with a sampling frequency of 44.1 kHz at 128 kbps (CBR). When transferring from an MP3/WMA disc, MP3/WMA files are transferred with the same bit rate as the original MP3/WMA files.

- Connect the USB device to the **1** (USB) port **17**.
- Press CD **18** to turn on the CD function.
- Place the disc you want to transfer in the CD compartment.

■ CD SYNC transfer

To transfer a whole disc Proceed to step 4.

To transfer MP3/WMA files in a specific folder Set the play mode to folder play (**1**) or folder repeat play (**4**), and then press **◀ 4** or **▶ 7** repeatedly to select the folder you want.

To transfer only your favorite tracks/files Perform step 1 to 5 of "Creating your own program (Program Play)" on the back page.

■ REC1 transfer

To transfer a single track/file Select and start playback of the track/file you want to transfer.

- Press REC **9**. "REC" flashes on the display and the unit starts calculating the amount of free space on the USB device.

To stop transferring Press **■ 14**. When the transferring source is a CD-DA track, the audio file is generated up to the point the transferring was stopped. When the source is an MP3 or WMA file, the file that is currently being transferred is not generated.

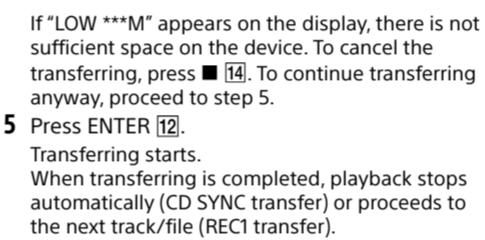

If "LOW ***M" appears on the display, there is not sufficient space on the display. To cancel the transferring, press **■ 14**. To continue transferring anyway, proceed to step 5.

Folder and file generation rules When first transferring to a USB device, a "MUSIC" folder and its sub folder "SONY" are created directly below the "ROOT" folder. Folders and files are generated within the "CD" folder under the "SONY" folder based on the following rules.

CD SYNC transfer		
Transferring source	Folder name	File name
MP3/WMA	Same as the transferring source*1,2	
CD-DA	"ALBUM001"*3	"TRACK001"*4

REC1 transfer		
Transferring source	Folder name	File name
MP3/WMA	"REC1"*5	
CD-DA		"TRACK001"*4

*1 In Program Play mode, the folder name is "FLDRxx", and the file name depends on the transferring source.
*2 Up to 32 characters (including a file extension for a file name) can be displayed.
*3 Folder names are assigned in sequential order up to a maximum of 256 (including the "ROOT" and "MUSIC" folders).
*4 File names are assigned in sequential order.
*5 A new file is transferred to the "REC1" folder each time single track transfer is performed.

To erase audio files or folders from the USB device

- Press **◀ 4** or **▶ 7** repeatedly to select an audio file, or press **◀ 4** or **▶ 7** repeatedly to select a folder.
- Press ERASE **11**. "ERASE?" appears on the display.
- Press ENTER **12**. "TRACK ERASE?" or "FOLDER ERASE?" appears on the display.
- Press ENTER **12**. The selected audio file or folder is erased, and "COMPLETE" appears on the display.

- Notes**
 - If you start transferring in shuffle play or repeat play mode, the selected play mode is automatically changed to normal play.
 - Do not remove the USB device during transferring or erase operations. Doing so may corrupt the data on the device or damage the device itself.
 - While transferring, no sound is output and "HI-SPEED" appears on the display.
 - CD-TEXT information is not transferred in the created MP3 files.
 - Transferring stops automatically if:
 - The USB device runs out of space during transferring.
 - The number of audio files and folders on the USB device reaches the limit that the unit can recognize.
 - Non-MP3/WMA/AAC format files or sub folders in the folder are not erased.
 - Radio sound and sound from an optional component cannot be transferred to a USB device.

Note on copyright-protected content The transferred music is limited to private use only. Use of the music beyond this limit requires permission from the copyright holders.

Listening to music wirelessly on a BLUETOOTH device

Using the BLUETOOTH connection, you can listen to music from wirelessly connected BLUETOOTH devices such as mobile phones, smartphones, music players, etc.



Pairing this unit with a BLUETOOTH device

BLUETOOTH devices must be "paired" with each other beforehand. Once BLUETOOTH devices are paired, there is no need for pairing again, unless the pairing information is cleared. Choose the pairing method below depending on your device.

Pairing with an NFC-incompatible BLUETOOTH device: see **Pattern A**

Pairing with an NFC-compatible smartphone: see **Pattern B**

Pattern A

Pairing with an NFC-incompatible BLUETOOTH device Keep the BLUETOOTH connection to the unit within 1 meter of each other for this operation.

- Press BLUETOOTH **18** to turn on the BLUETOOTH function. If no devices have been paired, such as when you press BLUETOOTH **18** for the first time after you purchase the unit, the unit automatically enters pairing mode, and the BLUETOOTH indicator **8** and "PAIRING" flash on the display.



When pairing with two or more BLUETOOTH devices Hold down BLUETOOTH (-PAIRING) **18** until two beeps are heard.

- Turn on the BLUETOOTH function of the BLUETOOTH device.
- Perform the pairing procedure on the BLUETOOTH device to detect the unit.
- Select "ZS-RS60BT" shown on the display of the BLUETOOTH device. If "ZS-RS60BT" does not appear on the device's display, repeat from step 2.
- If Passcode* input is required on the display of the BLUETOOTH device, input "0000." The BLUETOOTH connection is established. "BT AUDIO" appears on the display.
 - "Passcode" may be referred to as "Passkey," "PIN code," "PIN number," or "Password."



Tip You can pair up to 8 BLUETOOTH devices. If the 9th BLUETOOTH device is paired, the oldest paired device will be deleted.

- Notes**
 - Pairing mode of the unit is cancelled after about 5 minutes, and the BLUETOOTH indicator **8** flashes. If pairing mode is cancelled while performing this procedure, start over from step 1.
 - The passcode of the unit is fixed as "0000." The unit cannot be paired with a BLUETOOTH device whose Passcode is not "0000."

Pattern B

Pairing with an NFC-compatible smartphone By just touching the unit with an NFC-compatible smartphone, the unit is turned on and switched to the BLUETOOTH function automatically and then paired and connected to the smartphone.

Compatible smartphones Smartphones with the NFC function built-in (OS: Android™ 2.3.3 or later, excluding Android 3.x)

What is "NFC"? NFC (Near Field Communication) is a technology enabling short-range wireless communication between various devices, such as mobile phones and IC tags. Thanks to the NFC function, data communication can be achieved easily just by touching the relevant symbol or designated location on NFC compatible devices.

- Turn on the NFC function of the smartphone. For details, refer to the operating instructions supplied with the smartphone.

If your smartphone OS is Android 2.3.3 or later, but earlier than Android 4.1 Proceed to step 2.

If your smartphone OS is Android 4.1 or later Proceed to step 4.

- Download and install the app "NFC Easy Connect" on the smartphone. "NFC Easy Connect" is an original app by Sony for Android phones, and is available at the Google Play™ Store. Search for "NFC Easy Connect" or scan the following two-dimensional code to download and install the free app. Communication fees are required to download the app. The App may not be available in some countries and/or regions.

Tip For some smartphones, One-touch connection may be available without downloading the app "NFC Easy Connect." In that case, the operation and specifications may be different from the description here. For details, refer to the operating instructions supplied with the smartphone.

For the two-dimensional code: Use a two-dimensional code reader app.



- Start the app "NFC Easy Connect" on the smartphone. Make sure that the application screen is displayed.

- Touch the unit with the smartphone. Keep touching the smartphone to the N mark **20** on the unit until the smartphone responds.

Note If your smartphone screen is locked, the smartphone will not function. Release the lock, then touch the smartphone to the N mark **20** again.

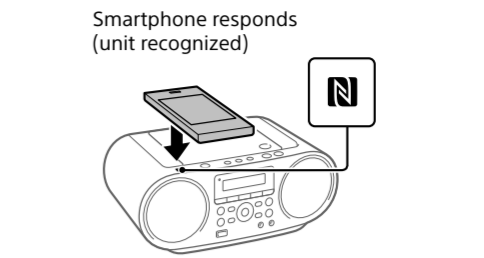

Follow the on-screen instructions to establish the connection. When the BLUETOOTH connection is established, "BT AUDIO" appears on the display.



- Tips**
 - If it is difficult to establish the connection, try the following:
 - Activate the app "NFC Easy Connect" and move the smartphone slightly across the N mark **20** on the unit.
 - If the smartphone is in a case, remove it.
 - Touch the unit with the smartphone again to disconnect.
 - If you have multiple NFC-compatible devices, just touch the smartphone to a different device to switch the connection to that device. For example, when your smartphone is connected with NFC-compatible headphones, just touch the smartphone to the unit to change the BLUETOOTH connection to the unit (One-touch connection switching).

Listening to music

Check the following before operating the unit.
— The BLUETOOTH function of the BLUETOOTH device is turned on.
— Pairing has been completed. (See "Pairing this unit with a BLUETOOTH device.")

- Make the BLUETOOTH connection between the unit and the device.

For an NFC-incompatible BLUETOOTH device Press BLUETOOTH **18** to turn on the BLUETOOTH function.

The last connected device will be connected automatically.

For an NFC-compatible smartphone Touch the smartphone to the N-Mark **20** on the unit.

- Start playback of an audio source such as music, videos, games, etc., on the device. Refer to the instruction manual of your device for details on playback operations.

Tip To adjust the volume, set the volume of the BLUETOOTH device or the smartphone to the moderate level, and then press VOL - or + **4** on the unit.

To terminate a BLUETOOTH connection Do any of the following.

- Turn off the BLUETOOTH function of the BLUETOOTH device. For details, refer to the operating instructions supplied with the device.
- Turn off the BLUETOOTH device.
- Change the function of the unit.
- Turn off the unit.
- Touch the unit with the smartphone again to disconnect (NFC-compatible smartphones only).

To clear the paired device information

- Hold down ERASE **11** until "BT RESET" appears on the display.
- Press ENTER **12**. When the paired device information is cleared, "COMPLETE" appears on the display. To cancel the reset operation, press **■ 14**.

Listening to the radio

- Press FM/AM **18** repeatedly to turn on the radio function and select the band "FM" or "AM."
- Hold down TUNE + or - **7** until the frequency digits begin to change on the display. The unit automatically scans the radio frequencies and stops when it finds a clear station. If you cannot tune to a station using automatic tuning mode, press TUNE + or - **7** repeatedly to change the frequency step by step. When an FM stereo broadcast is received, "ST" lights up on the display.

Note The unit of frequency of tuned stations is MHz for the FM band and kHz for the AM band.

To change the FM/AM tuning interval (This function is only available on models for some countries/regions. See the radio section in "Specifications.") The FM/AM tuning interval can be changed if necessary using the following procedure.

- Press FM/AM **18** repeatedly to select a band.
- Hold down ENTER **12** until "FM-xx" or "AM-xx" flashes on the display.
- Hold down FM/AM **18** until the current tuning step appears.
- Press **◀ 4** or **▶ 7** to select the desired tuning step.
- Press ENTER **12**. The selected tuning interval erases all the FM/AM preset stations stored in the unit. Reset your preset stations after changing the tuning interval.

To improve radio reception Use the radio in a place where radio signals can be easily received, such as near a window. Also, adjust the antenna (FM) or reorient the unit itself (AM) for good reception.

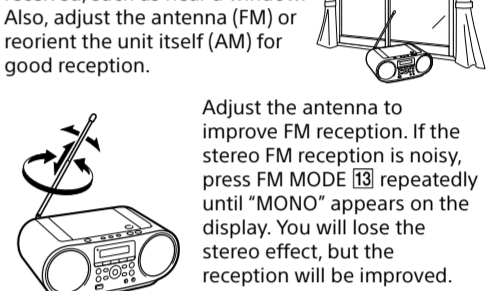

If the reception problem still persists, try changing the installation location. Avoid places such as the following:

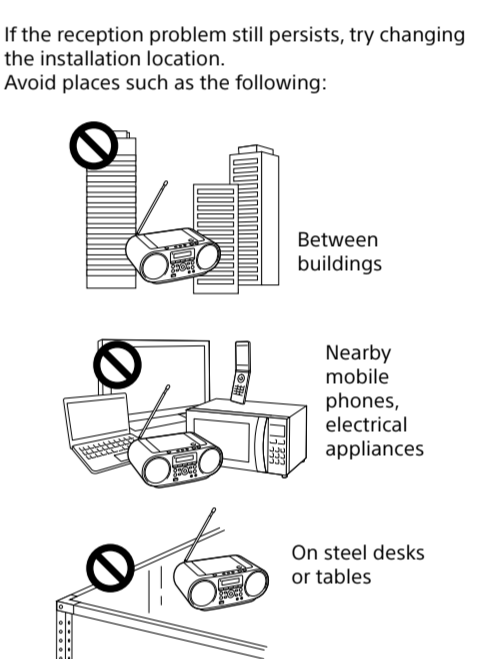

Presetting stations to FAVORITE RADIO STATIONS

You can preset up to three favorite stations to FAVORITE RADIO STATIONS (1-3) buttons. Assign one FM or AM program for each button.

- Press FM/AM **18** repeatedly to turn on the radio function and select the band "FM" or "AM."
- Tune to the station you want to preset.
- Press and hold the desired FAVORITE RADIO STATIONS (-SET) (1-3) button **21** until you hear a beep. The tuned station is preset to the selected button of FAVORITE RADIO STATIONS (1-3) and the same number as that of the button will light up on the display.

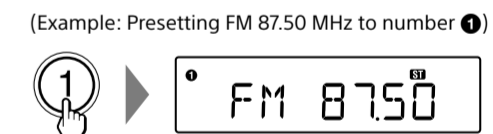

To change the preset station Repeat steps 1 to 3. The preset station on the button will be replaced by the new one.

Listening to preset stations with FAVORITE RADIO STATIONS

Press the desired FAVORITE RADIO STATIONS (1-3) button **21**.

Note To prevent the preset from being changed by mistake, do not hold down the button. If doing so, the preset on the button will be replaced by the currently tuned station.

Other Operations

Using the display

Checking the information of an audio CD
Press **■** **[4]** twice to cancel Resume Play. The total number of tracks and total playing time appear on the display.

Checking MP3/WMA/AAC file information
Press DISPLAY **[6]** repeatedly while playing an MP3/WMA file on the disc or an MP3/WMA/AAC file on the USB device.

The display changes as follows:

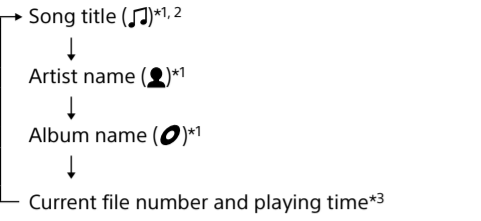

*1 If the file does not have corresponding ID3, WMA or AAC tag information, the file name, "NO ARTIST", and "NO ALBUM" scroll on the display instead of the song title, artist name, and album name.
*2 The function name is displayed for 2 seconds before the song title appears.
*3 The artist name or album name will change to this in a few seconds.

Checking the connected BLUETOOTH device name
Press DISPLAY **[6]** while connecting the BLUETOOTH device.

Checking the radio information
Press DISPLAY **[6]** repeatedly while listening to the radio.

The display changes as follows:

Preset number*1,2 ← Frequency

*1 A preset number is displayed only when you are listening to the preset radio station.
*2 The display automatically returns to the frequency display after 2 seconds have elapsed.

Selecting play mode

You can set the unit to play tracks or files repeatedly or in random order while a disc/USB device is stopped.

Press PLAY MODE **[3]** repeatedly.



Each time you press the button, the indication changes as follows:

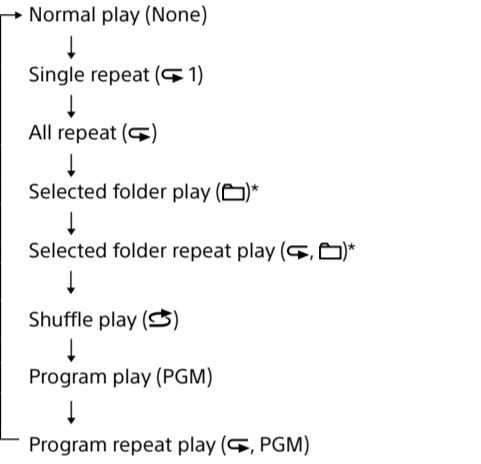

* These functions are available only when playing MP3/WMA files on an MP3/WMA disc or MP3/WMA/AAC files on a USB device.

Playing tracks/files repeatedly (Repeat Play)

You can set the unit to repeatedly play CD-DA tracks on an audio CD, MP3/WMA files on a CD-R/CD-RW disc, or MP3/WMA/AAC files on a USB device in normal and program play modes.

- Press CD **[8]** or USB **[8]** to turn on the CD or USB function.
- Proceed as follows.

To repeat	Do this
A single track/file	<ol style="list-style-type: none">Press PLAY MODE [3] repeatedly until ↺ 1* appears. Press ◀◀ or ▶▶ [7] to select a track/file that you want to repeat. Press ▶▶ [5].
All tracks/files	<ol style="list-style-type: none">Press PLAY MODE [3] repeatedly until ↺* appears. Press ▶▶ [5].
A selected folder on an MP3/WMA disc or USB device	<ol style="list-style-type: none">Press PLAY MODE [3] repeatedly until 📁 and ↺* appear. Select a folder by pressing ◀ + or ▶ [7]. Press ▶▶ [5].
Programmed tracks/files	<ol style="list-style-type: none">Program tracks/files (see "Creating your own program (Program Play)"). Press PLAY MODE [3] until "PGM" and ↺* appear on the display. Press ▶▶ [5].

To cancel Repeat Play
Press **■** **[4]** to stop playback, and then press PLAY MODE **[3]** repeatedly until **↺*** (or **↺ 1***) disappears from the display.

Playing tracks/files in random order (Shuffle Play)

You can set the unit to play CD-DA tracks on an audio CD, MP3/WMA files on a CD-R/CD-RW disc or MP3/WMA/AAC files on a USB device in random order.

- Press CD **[8]** or USB **[8]** to turn on the CD or USB function.
- Press PLAY MODE **[3]** repeatedly until **🔀*** appears on the display.
- Press **▶▶** **[5]** to start Shuffle Play.

To cancel Shuffle Play
Press **■** **[4]** to stop playback, and then press PLAY MODE **[3]** repeatedly until **🔀*** disappears from the display.

Tip
During Shuffle Play, you cannot select the previous track/file by pressing **◀◀** **[7]**.

Creating your own program (Program Play)

You can arrange the playing order of up to 25 tracks/files on a disc/USB device.

- Press CD **[8]** or USB **[8]** to turn on the CD or USB function.
- Press PLAY MODE **[3]** repeatedly until "PGM" appears on the display.
- Press **◀◀** or **▶▶** **[7]** to select a track/file. When you want to specify a folder that contains MP3/WMA/AAC files, press **📁** + or **▶** **[7]** first to select a folder, and then press **◀◀** or **▶▶** **[7]** to select a file.

4 Press ENTER **[2]**.

The track/file is programmed. The program step number appears, followed by the total playing time. (Example: audio CD)

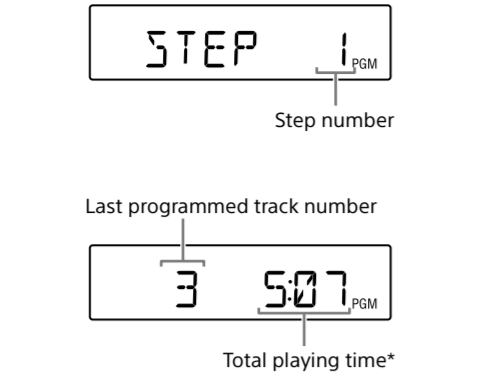

* "----" appears when programming an MP3/WMA disc/USB device or when the total playing time is longer than 100 minutes.

- Repeat steps 3 and 4 to program additional tracks/files.
- Press **▶▶** **[5]** to start Program Play. To play the same program again, press **▶▶** **[5]**. Note that the created program is cleared in the following cases:
 - When you open the CD compartment.
 - When you connect another USB device.
 - When you turn off the power of the unit in the CD function.

Note
If you try to program 26 tracks/files or more, "FULL" flashes on the display.

To display programmed track/file information
After creating your own program, you can check information about programmed tracks/files.

Press DISPLAY **[6]** repeatedly and the display changes as follows:

Total number of steps ↔ Last programmed track/file number and the total playing time*

* "----" appears for MP3/WMA discs and USB devices.

To cancel Program Play

Press **■** **[4]** to stop playback, and then press PLAY MODE **[3]** repeatedly until "PGM" disappears from the display.

To delete all tracks/files in the current program
Stop playback, and then press **■** **[4]**. "NO STEP" appears and you can create a new program, following the procedure "Creating your own program (Program Play)".

Presetting radio stations

You can store radio stations in the unit's memory. You can preset up to 30 radio stations, 20 for FM and 10 for AM.

- Press FM/AM **[8]** repeatedly to turn on the radio function and select the band "FM" or "AM."
- Hold down FM/AM **[8]** until "AUTO" flashes on the display.

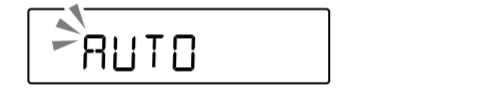

- Press ENTER **[2]** to store the station. The stations are stored in memory from lower frequencies to higher ones.

If a station cannot be preset automatically
You need to preset a station with a weak signal manually.

- Press FM/AM **[8]** repeatedly to select a band.
- Tune to the desired station.
- Hold down ENTER **[2]** until "FM-xx" or "AM-xx" flashes on the display. (Example: FM)

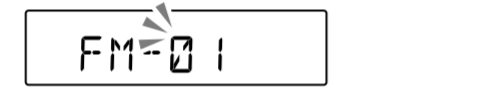

- Press PRESET + or **[-]** until the preset number for the station you want flashes on the display.
- Press ENTER **[2]** to store the station. If another station is already assigned to the selected preset number, that station is replaced by the new one.

Tip
The preset radio stations remain in the unit's memory even in the following situations.
—The AC power cord is unplugged.
—The batteries are removed.

Listening to preset radio stations

- Press FM/AM **[8]** repeatedly to turn on the radio function and select the band "FM" or "AM."
- Press PRESET + or **[-]** to select a stored preset number for the desired radio station.

Using the Sleep Timer

You can set the unit to turn off automatically after a set time has elapsed.

- Press SLEEP **[8]**. The default setting ("90") appears and the "SLEEP" indicator lights up on the display.
- Press SLEEP **[8]** repeatedly to select the desired setting.

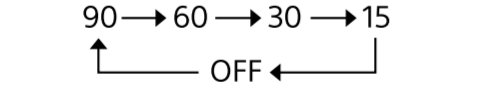

Each time you press the button, the duration (in minutes) changes on the display, and the selected setting is confirmed automatically after about 4 seconds.

Tip
You can check the time left until the unit turns off by pressing SLEEP **[8]** again after setting the sleep timer.

Connecting optional components

You can enjoy the sound from an optional component, such as a portable digital music player, through the speakers of this unit. Be sure to turn off the power of each component before making any connections. For details, refer to the instruction manual of the component to be connected.

- Connect the AUDIO IN jack **[5]** to the line output jack of the portable digital music player or other component using an audio connection cable (not supplied).
- Turn the connected component on.
- Press AUDIO IN **[8]** and start playing sound on the connected component. The sound from the connected component is output from the speakers.

To connect the unit to a TV or video recorder/player, use an extension cable (not supplied) with a stereo-mini jack on one end and two phono plugs on the other end.

Additional Information

Compatible devices

Compatible USB devices
Compatibility requirements for the USB devices are as follows. Before using a device with this unit, check that it meets the requirements.

- Compliance with USB 2.0 (Full Speed)
- Supports Mass Storage mode*

* Mass Storage mode is a mode that allows a USB device to become accessible to a host device, enabling file transfers. Most USB devices support Mass Storage mode.

Notes on the USB device

- When a USB device is connected, the unit reads all the files on the device. If there are many folders or files on the device, it may take a long time for the unit to finish reading them.
- Do not connect a USB device to the unit through a USB hub.
- With some connected USB devices, after an operation is performed, there may be a delay before it is performed by this unit.
- This unit may not support all the functions provided with a connected USB device.
- The playback order on this unit may differ from the playback order on a connected USB device.

Compatible BLUETOOTH devices
Compatibility requirements for the devices are as follows. Before using a device with this unit, check that it meets the requirements.

- Devices must conform to BLUETOOTH Standard version 2.1 + EDR.
- Devices must support A2DP (Advanced Audio Distribution Profile) and AVRCP (Audio/Video Remote Control Profile).

For the latest information on compatible BLUETOOTH devices, including NFC-compatible smartphones, check the websites below.

For customers in Europe:

<http://www.sony.eu/support>

For customers in Latin America:

<http://www.sony.com/LA>

For customers in other countries/regions:

<http://www.sony-asia.com/support>

What is BLUETOOTH wireless technology?

BLUETOOTH wireless technology is a short-range wireless technology that enables wireless data communication between digital devices, such as a computer and digital camera. BLUETOOTH wireless technology operates within a range of about 10 m. Connecting two devices as necessary is common, but some devices can be connected to multiple devices at the same time.

You do not need to use a cable for connection, nor is it necessary for the devices to face one another, such is the case with infrared technology. For example, you can use such a device in a bag or pocket. BLUETOOTH standard is an international standard supported by thousands of companies all over the world, and employed by various companies worldwide.

Maximum communication range
Maximum communication range may shorten under the following conditions.
—There is an obstacle such as a person, metal, or wall between the unit and BLUETOOTH device.
—A wireless LAN device is in use near the unit.
—A microwave oven is in use near the unit.
—A device that generates electromagnetic radiation is in use near the unit.
—The unit is placed on a shelf made of steel.

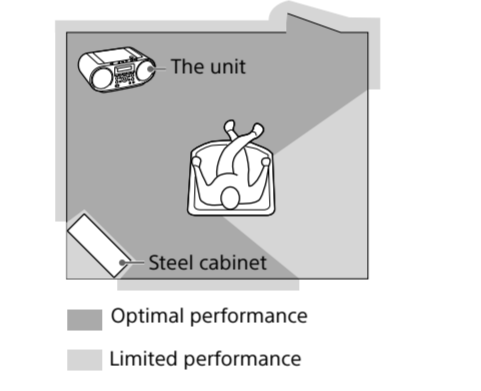

■ Optimal performance

■ Limited performance

Interference from other devices

Because BLUETOOTH devices and wireless LAN (IEEE802.11b/g/n) use the same frequency, microwave interference may occur and resulting in communication speed deterioration, noise, or invalid connection if the unit is used near a wireless LAN device. In such a case, perform the following.
—Use the unit at least 10 m away from the wireless LAN device.

—If the unit is used within 10 m of a wireless LAN device, turn off the wireless LAN device.
—Use the BLUETOOTH device as close to the unit as possible.

Interference to other devices
Microwaves emitting from a BLUETOOTH device may affect the operation of electronic medical devices. Turn off the unit and BLUETOOTH devices in the following locations, as it may cause an accident.
—where inflammable gas is present, in a hospital, train, airplane, or a gas station
—near automatic doors or a fire alarm

Notes

- To be able to use the BLUETOOTH function, the BLUETOOTH device to be connected requires the same profile as the unit's. Note also that even if the same profile exists, devices may vary in function depending on their specifications.
- Due to the characteristic of BLUETOOTH wireless technology, the sound played on the unit is slightly delayed from the sound played on the BLUETOOTH device during listening to the music.
- This unit supports security capabilities that comply with the BLUETOOTH standard to provide a secure connection when the BLUETOOTH wireless technology is used, but security may not be enough depending on the setting. Be careful when communicating using BLUETOOTH wireless technology.
- We do not take any responsibility for the leakage of information during BLUETOOTH communication.
- A device featuring the BLUETOOTH function is required to conform to the BLUETOOTH standard specified by Bluetooth SIG, and be authenticated. Even if the connected device conforms to the above mentioned BLUETOOTH standard, some devices may not be connected or work correctly, depending on the features or specifications of the device.
- Noise or sound skips may occur depending on the BLUETOOTH device connected with the unit, the communication environment or the usage environment.

Precautions

Discs that this unit CAN play

- Audio CD (CD-DA) tracks
- CD-R/CD-RW that contains MP3/WMA files and is finalized*2 correctly.

*1 CD-DA is the abbreviation for Compact Disc Digital Audio. It is a recording standard used for audio CDs.

*2 Finalizing is the process to make the CD-R/CD-RW discs playable on the consumer disc player products, and the finalizing can be enabled or disabled as optional settings during disc creation in most recording software.

Discs that this unit CANNOT play

- CD-R/CD-RW other than those recorded in audio CD format or formats conforming to ISO 9660 Level 1/Level 2 or Joliet.
- CD-R/CD-RW of poor recording quality, CD-R/CD-RW with scratches or that is dirty, or CD-R/CD-RW recorded using an incompatible recording device.
- CD-R/CD-RW that is unfinalized or finalized incorrectly

Notes on discs

- Clean the CD with a cleaning cloth if the disc is dirty. Wipe the disc from the center out. If there are scratches, dirt or fingerprints on the disc, a tracking error may occur.
- Do not use solvents such as benzine, thinner, commercially available cleaners or anti-static spray intended for vinyl LPs.
- Do not expose the CD to direct sunlight or heat sources such as hot air ducts, or leave it in a car parked in direct sunlight as there can be a considerable rise in temperature inside the car.
- Do not stick paper or a sticker on the CD, or scratch the surface of the CD.
- After playing, store the CD in its case.

Note on DualDiscs

A DualDisc is a two sided disc product which makes DVD recorded material on one side with digital audio material on the other side. However, since the audio material side does not conform to the Compact Disc (CD) standard, playback on this product is not guaranteed.

Music discs encoded with copyright protection technologies

This product is designed to playback discs that conform to the Compact Disc (CD) standard. Recently, various music discs encoded with copyright protection technologies are marketed by some record companies. Please be aware that among those discs, there are some that do not conform to the CD standard and may not be playable by this product.

On safety

As the laser beam used in the CD player section is harmful to eyes, do not attempt to disassemble the casing. Refer servicing to qualified personnel only.

Should any solid object or liquid fall into the unit, unplug the unit, and have it checked by qualified personnel before operating it any further.

Discs with non-standard shapes (e.g., heart, square, star) cannot be played on this unit. Attempting to do so may damage the unit. Do not use such discs.

On power sources

- For AC operation, use the supplied AC power cord; do not use any other cord.
- Unplug the unit from the wall outlet if it is not to be used for an extended period of time.
- When not using the batteries, remove them to avoid damage that can be caused by battery leakage or corrosion.

On placement

- Do not leave the unit in a location near heat sources, in a place subject to direct sunlight, excessive dust or mechanical shock, or in a car subject to the direct rays of the sun.
- Do not place the unit on an inclined or unstable cabinet.
- Do not place anything within 10 mm of the rear of the cabinet. The ventilation openings must be unobstructed for the unit to operate properly and prolong the life of its components.
- Since a strong magnet is used for the speakers, keep personal credit cards using magnetic coding or spring-wound watches away from the unit to prevent possible damage from the magnet.

On operation

- If the unit is brought directly from a cold to a warm location, or is placed in a very damp room, moisture may condense on the lens inside the CD player section. Should this occur, the unit will not operate properly. In this case, remove the CD and wait about an hour for the moisture to evaporate.

On handling the unit

- Do not leave the CD compartment open to avoid dust and debris contamination.

On cleaning the cabinet

Clean the cabinet, panel and controls using a soft cloth slightly moistened with a mild detergent solution. Do not use any type of abrasive pad, scouring powder, or solvent, such as alcohol or benzine.

If you have any questions or problems concerning your unit, consult your nearest Sony dealer.

Troubleshooting

General

The power does not turn on.

- Make sure the AC power cord is connected to the wall outlet securely.
- Make sure the connector of AC power cord is inserted into the AC IN jack securely.
- Check if the batteries are inserted correctly, matching the polarities.
- Replace all the batteries with new ones when the OPR/BATT indicator **[8]** dims.

There is no sound.

- Make sure the appropriate function is selected for the music or sound source you want to listen to.
- Unplug the headphones when listening through speakers.

The sound is noisy.

- Is someone using a mobile phone or other equipment emitting radio waves near the unit? If so, move the unit and the BLUETOOTH device away from such devices. Devices such as mobile phones, etc., can affect BLUETOOTH communication.

A small humming noise is heard from the radio

- This is not a malfunction. You may hear a small humming noise from the radio depending on the status of the power supply.

“NOT IN USED” appears.

- You pressed an invalid button.

CD/MP3/WMA player

The CD player does not play even when a CD is in place.

- Place the CD with the label side up.
- Clean the CD.
- Take out the CD and leave the CD compartment open for about an hour to dry moisture condensation.
- The CD-R/CD-RW is blank or unfinalized.
- There are no playable MP3/WMA files on the disc.
- There is a problem with the quality of the CD-R/CD-RW, recording device or application software.
- Replace all the batteries with new ones when the OPR/BATT indicator **[8]** dims.

- “NO CD” appears when the disc is loaded.
- No disc is set in the CD compartment. Set a disc.
- The CD may have a reading problem. Replace the disc.
- The CD may be placed upside down. Place the disc with the label side up.
- An unplayable disc (DVD, BD, etc.) is loaded. Replace the disc.

“NO TRACK” appears on the display when the disc is loaded.

- No audio files recorded in supported formats, or a file to be played back has an unsupported file extension.

“DISC ERR” appears when the disc is loaded.

- The CD may be dirty. Clean the disc.
- The CD may have scratches. Replace the disc.
- The CD may have a reading problem. Replace the disc.
- A blank disc may be set in the CD compartment.

The sound drops out.

- Reduce the volume.
- Clean the CD, or replace it if the CD is badly damaged.
- Place the unit in a location free from vibrations.
- Clean the lens with a commercially available blower.
- The sound may drop out or noise may be heard when using a poor quality CD-R/CD-RW or if there is a problem with the recording device or application software.

Starting playback takes more time than usual.

- The following discs take a longer time to start playback.
—A disc recorded with a complicated tree structure.
—A disc that has many folders or non-MP3/WMA files.

USB device

The USB device does not work properly.

- If you connect an incompatible USB device, the following problems may occur.
—The USB device is not recognized.
—File or folder names are not displayed on this unit.
—Playback is not possible.
—The sound skips.
—There is noise.
—The sound output is distorted.

“OVER CURRENT” appears and the unit stops off automatically.

- An abnormal level has been detected in the electrical current from the ⚡ (USB) port **[7]**. In this case, remove the USB device from the ⚡ (USB) port **[7]** and reconnect the USB device, and then turn the unit again. If this problem persists after turning on the power of the unit, contact your nearest Sony dealer.

There is no sound.

- The USB device may be connected incorrectly. Turn off the unit and reconnect the USB device. Then turn on the unit.

There is noise, skipping, or distorted sound.

- Turn off the unit and reconnect the USB device. Then turn on the unit again.
- The music data itself contains noise, or the sound is distorted. Noise may have entered during the creation of audio files. Try re-creating audio files and use them to play on this unit.

The USB device cannot be connected to the ⚡ (USB) port **[7].**